



Beyond boundaries

Course Guide 16-18s
2022-23

Look beyond today



This course guide outlines the courses we hope to offer in September 2022 and information is correct at the time of printing. However, changes to our provision and entry requirements may occur. Please check details at: www.ncc london.ac.uk

Contents

Welcome	5
Reasons to choose New City College	6
Ardleigh Green Campus	8
Attlee A Level Academy	10
Epping Forest Campus	12
Hackney Campus	14
Havering Sixth Form Campus	16
Rainham Construction & Engineering Campus	18
Redbridge Campus	20
Tower Hamlets Campus	22
Our student support	24
University progression	26
Study levels explained	28
Apprenticeships & Work Experience	30
A Levels	34
At Attlee A Level Academy	36
At Havering Sixth Form Campus	40
BTEC & Vocational	50
Business & Enterprise	52
Computing & Digital Industries	58
Construction & Building Services	62
Creative Arts, Design & Media	70
Early Years	78
Engineering	82
English for Speakers of Other Languages (ESOL)	86
Foundation Learning SEND	88
Hairdressing & Beauty Therapy	96
Health Sciences & Social Care	102
Hospitality & Culinary Arts	106
Motor Vehicle Technologies	110
Performing Arts	114
Science	118
Sport & Fitness	122
Tourism & Aviation	130
Uniformed Public Services	134
14-16 Key Stage 4	136
Courses for Adults (19+)	137
What's Next	138



Welcome

We are pleased that you are thinking about studying at New City College.

We are the largest college in east London and Essex, with campuses in Epping Forest, Hackney, Havering, Redbridge and Tower Hamlets. Wherever you live, we are sure to have a campus close to you, offering a great choice of career enhancing courses. We are one of the most successful colleges in London, with high achievement rates at all of our campuses.

Our course offer includes A Levels at our Attlee A Level Academy and Havering Sixth Form campuses. Our BTEC and vocational courses focus on specific career and industry specialisms.

We hold a number of open events at all our campuses during the year. If you are

unable to come along in person, don't worry! We would love to give you a virtual tour – please visit our website for full details.

We aim to keep parents and carers up-to-date throughout the year. We use ProMonitor to view, record and track a wide range of information about our students, such as their attendance, timetable, progress and more.

Our students thrive with us and go on to achieve great things at university or in employment. Whatever your ultimate career ambition, we are sure that we can help you to prepare for and become equipped to enter your chosen career.

We look forward to welcoming you to our great college.

We are now cashless! You can make payments for food and drink at the college canteen and for trips and other purchases, all using debit/credit card or your ID card, via WisePay.

Once you are a student you will receive an email with your WisePay login details.



Reasons to choose New City College



200+
Courses linked to
career outcomes



**High
achievement**
and success rates
at all our campuses



Campuses in
**Epping Forest, Hackney, Havering,
Redbridge & Tower Hamlets**



Strong
**STUDENT
SUPPORT
NETWORKS**
at all campuses



**GREAT
PARTNERSHIPS**
with leading
businesses and
companies giving
students access to
career networks



INTERNATIONAL TRIPS
Our students see the world! Trips to Italy, Greece,
Spain, Finland and China



TOP UNIVERSITY PROGRESSION
Cambridge, UCL, King's College, Queen Mary and more
We have partnerships with Bath Spa University and
University of Cumbria



Ardleigh Green Campus

Located in Hornchurch, close to London train lines and local bus routes, this campus is a perfect learning environment for students of all ages with industry standard facilities to prepare you for the world of work.

It includes a modern performance theatre, dance studios, motor vehicle repair workshop, media TV studio, art and design studio and science labs. There's also a stylish hair salon and beauty treatment rooms located in our Retreat salon.

The 'Square' is our name for the refectory where students can relax and engage with friends. It's also home to our careers and enrichment teams.

There is a coffee shop, hot food restaurant and well-stocked library and learning centre all on campus.



Attlee A Level Academy

Located at our Arbour Square campus, we offer one of the largest choices of A Levels in London.

You will benefit from outstanding teaching and learning, specialist personal tutors and an enrichment programme that will help you develop the skills to meet the demands of a changing world with confidence.

We have excellent links and strong partnerships with local businesses and universities, and offer work experience opportunities in finance, legal and STEM.

You will benefit from a study programme which offers a range of enrichment opportunities to help you to consolidate and contextualise your learning in the real world.

Our students progress to
Russell Group Universities

Cambridge, UCL, King's College and Queen Mary.



New City College
Attlee A Level Academy

Epping Forest Campus

Our campus is located in Loughton, close to London Underground and bus routes. We love our modern and spacious campus, which has some of the very best facilities in south Essex.

It includes a modern performance theatre, dance studio, large construction site, media studio, practical nursery room, art and design centre and brand-new sensory area and mock flat for our SEND learners. There's also a stylish hair salon and beauty treatment rooms located in our Inspire salon.

The 'Street' is our name for the meeting place and chill-out zones where students can relax and engage with friends. It's also home to our careers and enrichment teams. There is a Costa Coffee shop, hot food restaurant and a well-stocked library and learning centre.

Coming soon! Epping Sport & Wellness Centre

The centre will encompass brand new facilities for sport, fitness and wellbeing and will be open to use by college students and the general public.



Hackney Campus

Our Hackney campus is based in Hoxton, a lively part of east London, close to the City of London and the Old Street tech district.



Students love studying at our Hackney campus and we are sure you will too! There is lots of open space and light, airy meeting places, a well-stocked library and learning centre, a drop-in learning zone to provide support to students needing assistance with their studies, a sports centre and gym (free to students), real-world experience in our construction centre, Costa Coffee, hot food counter and Wrap it Up.

You can also use our student-led commercial restaurant OKN1, located on the campus, for food and drinks.



Havering Sixth Form Campus

Based in Hornchurch, we offer an impressive range of 34 A Level subjects complemented by a further eight BTEC certificate subjects (equivalent to one A Level) - one of the widest choices of subjects of any sixth form in the country.

We also offer a range of full-time BTEC qualifications (equivalent to three A Levels) together with a small bespoke programme of courses at Level 2 which support students to gain the knowledge and skills required to progress to Level 3 study.

Our campus is safe and friendly with expert teachers and the industry standard facilities you need to be successful in your studies.

We are a bridge between school and the world of work or higher education. Our intention is to foster independence in a supportive environment.



Rainham Construction & Engineering Campus

We have invested £15million into our Rainham campus to create a sector-leading construction and engineering specialist training centre.

Jobs with these skills are booming and our students have the very best opportunity to succeed. Our students are enjoying their new campus and progress to a great variety of jobs from site trades to management positions.

We are proud of our specialist Construction and Engineering Centre offering state-of-the-art facilities, expert training and education. The new centre offers courses in Plumbing & Heating, Engineering, Electrical Installation & Electronics, alongside Brickwork, Carpentry and Painting & Decorating.

It is easy to get to - just off New Road, Rainham.



Redbridge Campus

Our main Redbridge campus is in Chadwell Heath (near to the King George Hospital).

Our campus is friendly, easy to get around and has lots of specialist facilities and onsite amenities including Wrap it Up, hot food counter, Costa Coffee and meeting places to relax or compare notes.

There is a well-stocked library and learning centre, i-zone for independent study and a gym (free to students).

There is also a busy enrichment programme throughout the year including talent shows, talks and sports along with a common room with game consoles and table tennis.



Tower Hamlets Campus

A vibrant, bustling and inclusive campus, with cutting edge technology.

You will benefit from excellent teaching and learning, industry standard resources, including our science laboratories; highly rated food outlets including Subway, Costa Coffee and a café hot food counter. This includes a wide range of vegetarian and halal food.

We are located in the heart of the community of Tower Hamlets and are easy to get to, with great transport links including the underground, the DLR and many bus routes passing by.

We have strong partnerships with local businesses and organisations in Canary Wharf where you can gain valuable work experience.

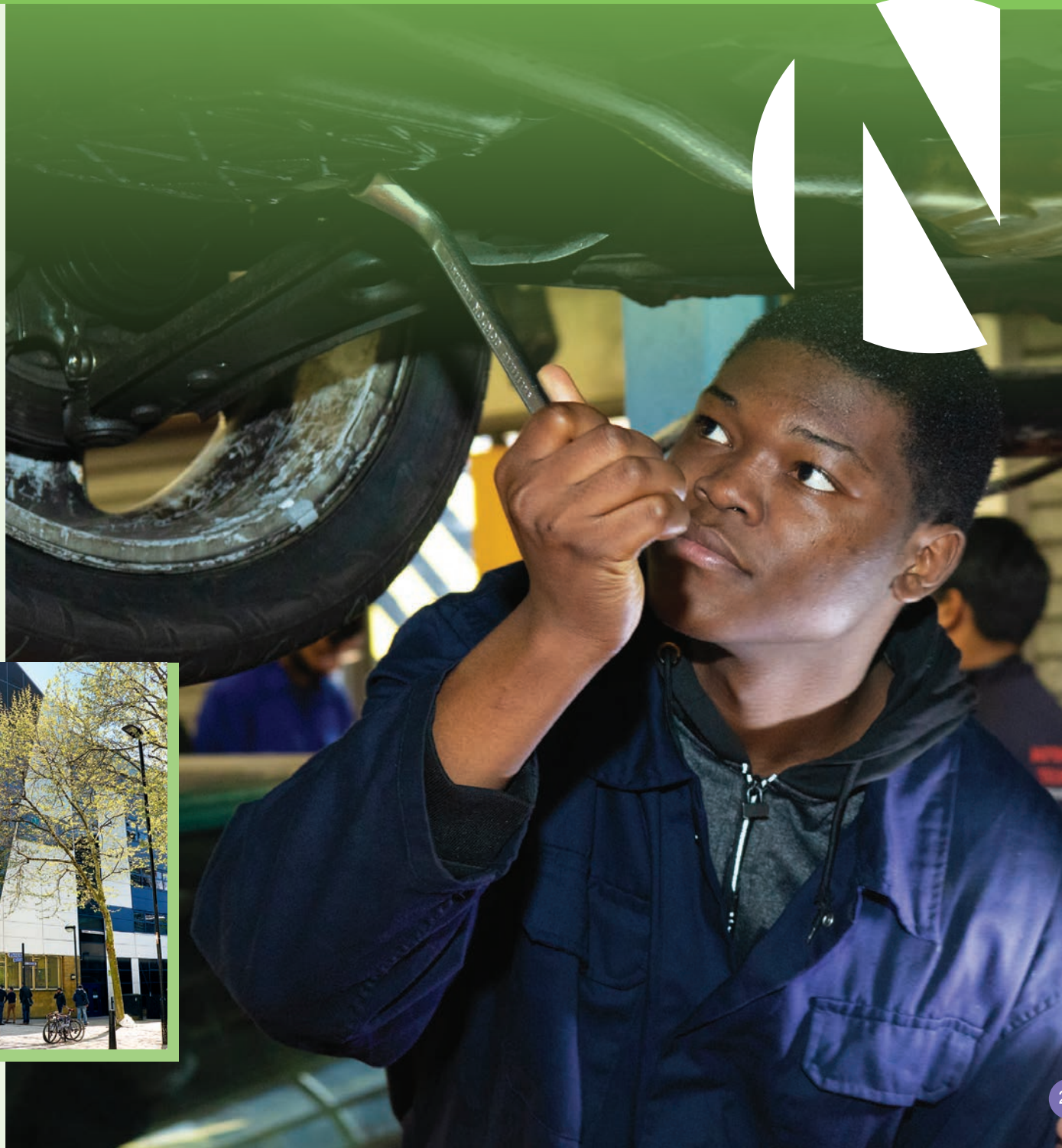

Our student support

We have a strong network of advice and support staff available to help students with their individual needs.

Student Services

Our student services teams are on hand to offer valuable information, advice and guidance to students, while supporting all aspects of college life, including financial support while studying.

Mental Health & Wellbeing

We offer practical support for students experiencing mental health difficulties. Support can include:

- Managing specific mental health conditions
- General advice on issues related to mental health and wellbeing
- Counselling therapeutic interventions
- Developing skills to manage mental health/wellbeing
- Assistance with referral to external services

Careers Advice

Our qualified careers advice team offer guidance about the education you will need to enter a particular career, employment options relating to your skills and interests and help creating and presenting your CV.

We will also support you with your UCAS application.



Mentor Support

Social justice charity Voyage provides one-to-one and group mentoring support. Mentors help students achieve and overcome challenges transitioning from college into the world of work.

Supported Learning

Many students benefit from tailored learning support. We will work with you to find the best way to help. We offer support:

- In class
- In small groups in our Learning Zone
- On a one-to-one basis

This will help you to develop:

- English and maths skills
- Study skills such as personal organisation or time management
- Independence and resilience

If you have a medical condition, sensory impairment, a learning disability/difficulty or physical disability, we will do all we can to support you in your learning.

Virtual Learning Environment (VLE)

The VLE is our interactive online learning resource where students can access course materials, keep in touch with tutors, submit assignments and track their progress.

Online Learning

We work hard to maintain a friendly and safe environment and have procedures in place, ready to teach remotely should this be necessary.

University progression

More than 1,400 students from New City College progress to university each year, with 146 students gaining places at Russell Group universities in London and across the UK in 2021.

They are studying fascinating degrees including natural science, law, chemistry, engineering, computer science, business and finance and architecture.

Cambridge*	University College London*	Queen Mary*
Southampton*	King's College*	York*
Manchester*	Leeds*	City
University of the Arts London	Sussex	School of Oriental & African Studies

*Member of the Russell Group of 24 of the UK's top research-led universities.

Study levels explained

Foundation Learning
(Entry & Level 1)
Intermediate
(Level 2)
Advanced
(Level 3)



If you have got:	Few or no GCSE passes	Entry criteria vary based on your subject. For many courses you will need to show some ability in required or related skills
You could study:	<ul style="list-style-type: none"> • Introductory programmes with personal development • Functional Skills in English and maths 	<ul style="list-style-type: none"> • BTEC Introductory Award/Certificate/Diploma • NVQ1/VRQ1 • Foundation Diploma with personal development • Functional Skills in English and maths
For how long?	One year	One year
Progression	Progress to Level 1	Employment or progress to Level 2 course or apprenticeship

Acceptance onto all courses is subject to specific entry requirements, an interview and a satisfactory reference. For some courses you may need to show us a portfolio of work or take an audition. Some courses require a DBS check.

<ul style="list-style-type: none"> • Four or more GCSEs at grade 3 (or equivalent) • Level 1 BTEC Diploma at Pass • NVQ1/VRQ1 • Entry criteria vary based on your subject. For many courses you will need to show some ability in required or related skills 	<ul style="list-style-type: none"> • Five or more GCSEs at grade 9-4 including English Language and maths • Level 2 BTEC Diploma at Merit or Distinction • NVQ2/VRQ2 • Where there are specific subjects required at GCSE we can discuss your grades with you when you come to enrol
<ul style="list-style-type: none"> • Level 2 BTEC Diploma • NVQ2/VRQ2 • Higher Diploma • Apprenticeship • You may also be able to re-sit GCSE English Language and maths 	<ul style="list-style-type: none"> • A Levels • Applied AS/A2 Levels • Level 3 BTEC Diploma/Extended Diploma • Apprenticeship • NVQ3/VRQ3 • T Levels
One year	Most courses are for two years. We also offer a small number of one year courses
Employment or progress to Level 3 course or apprenticeship	University, employment or higher apprenticeship

English and maths qualifications are essential for most employers and universities.

If you have not achieved GCSE English Language and maths at grades 9-4, you will receive the help you need to achieve these grades when you start your studies with us.

Apprenticeships

Employers all over the UK recognise and value apprenticeships as they show you have been trained in the skills they require. We deliver apprenticeship training at employers' premises or at one of our campuses.

Applying to become an Apprentice

- You must have lived in the UK for the past three years or more
- Be legally allowed to work in the UK
- Be aged 16 or older
- Undertake an assessment/skills test to ascertain your suitability for the course



Interested in becoming an Apprentice?

If you are working in any of the areas we have listed, please get in touch with us and let us know the name of your employer. We can speak to them directly about supporting you to train as an apprentice.



If you are not working and would like to see apprenticeship vacancies locally and from employers who work with us, contact us directly, or visit our website:

www.ncclondon.ac.uk/apprenticeships

APPRENTICESHIP OFFER	Level	Duration (Months)	Campus					
			AG	EF	HAC	RAI	RED	TH
ACCOUNTING / BUSINESS / LEGAL / MANAGEMENT								
Account / Finance Assistant	2	12	📍		📍			
Assistant Accountant	3	18	📍		📍			
Business Administrator	3	18	📍		📍			
Customer Service Practitioner	2	12	📍					
Customer Service Specialist	3	15	📍					
HR Support	3	18-24	📍					
HR Consultant/Partner	5	24	📍					
Junior Management Consultant	4	24	📍					
Operations/Departmental Manager	5	30	📍					
Team Leader/Supervisor	3	18	📍					
CATERING & HOSPITALITY								
Hospitality Team Member	2	12			📍			
Production Chef	2	12			📍			
Senior Production Chef	3	12			📍			
CHILDREN & YOUNG PEOPLE / TEACHING								
Early Years Educator	3	18	📍					
Early Years Practitioner	2	12	📍					
Learning & Skills Teacher	5	24			📍			
Teaching Assistant	3	18	📍					📍
CONSTRUCTION & ENGINEERING								
Advanced Carpentry & Joinery	3	15			📍	📍		
Bricklayer	2	30			📍	📍		
Carpentry & Joinery	2	24			📍	📍		
Installation Electrician	3	42			📍	📍		
Engineering Manufacturing Technician	4	42					📍	
Engineering Operative	2	18					📍	
General Welder (Arc Processes)	2	18					📍	

KEY

Campus: **AG** – Ardleigh Green, **EF** – Epping Forest, **HAC** – Hackney, **RAI** – Rainham, **RED** – Redbridge, **TH** – Tower Hamlets

APPRENTICESHIP OFFER	Level	Duration (Months)	Campus					
			AG	EF	HAC	RAI	RED	TH
Engineering Technician	3	42				📍		
Maintenance & Operations Engineering Technician	3	36-42				📍		
Mastic Asphalter	2	34			📍			
Painter & Decorator	2	36			📍	📍		
Plumbing & Domestic Heating Technician	3	46			📍	📍		
Property Maintenance Operative	2	18		📍				
Site Supervisor	4	36				📍		
Surveying Technician	3	24				📍		
Wall and Floor Tiler	2	30			📍			
Digital								
Digital Marketer	3	18						📍
Information Communication Technician	3	18						📍
Junior Content Producer	3	18			📍			
HAIR & BEAUTY								
Hair Professional	2	14		📍				
HEALTH & SOCIAL CARE								
Adult Care Worker	2	12-18						📍
Clinical Healthcare Support Worker	2	12						📍
Healthcare Support Worker	2	12-18						📍
Lead Adult Care Worker	3	18-24						📍
Leader in Adult Care	5	18						📍
Senior Healthcare Support Worker	3	18-24						📍
MOTOR VEHICLE								
Service & Maintenance Technician (Light Vehicle)	3	36	📍					
Vehicle Damage Panel Technician	3	36	📍					
Vehicle Damage Paint Technician	3	36	📍					
SCIENCE								
Laboratory Technician	3	24						📍

KEY

Campus: **AG** – Ardleigh Green, **EF** – Epping Forest, **HAC** – Hackney, **RAI** – Rainham, **RED** – Redbridge, **TH** – Tower Hamlets

Work Experience

As part of your study programme you will complete a work placement. This is **not optional**. It is just as important as your vocational course and English Language and maths.

This will vary from work experience of one week (35 hours) up to an Industry Placement of 45 - 60 days (or 315 - 360 hours). Your tutors will tell you the required amount for your programme of study.

Every student on a study programme will complete a period of work experience. If your course involves an industry placement, you will be told by your tutor. If your course does not include an industry placement but you would like to be considered for one, come and speak to us.

We aim to give you every opportunity to make sure that when you finish your course,

you are best placed to succeed, whether that is through higher level technical training, an apprenticeship, higher education or moving directly into employment. A meaningful work experience or industry placement will make you stand out against other applicants in the job market.

We'll support you in finding the right placement, though we do encourage you to approach employers yourself. This helps you to develop skills in applying for work.

You will have a designated contact at your campus who will come to your induction and start to work with you to secure your placement.

For further information:
e: wex@ncclondon.ac.uk
t: 020 7613 9433



A Levels



Students can choose from one of the largest choices of A Levels across London and Essex. This includes specialist subjects such as architecture, computer sciences, economics, geology, law, philosophy, as well as many other STEM, arts and humanities subjects.

You can study at one of two locations:

- **Attlee A Level Academy**

See page 10 for campus details

- **Havering Sixth Form**

See page 16 for campus details

Entry requirements

Students applying to study A Levels will need to have a minimum of five GCSEs at grades 9-5 including English Language and maths and where relevant, the subject they wish to study. Some A Level subjects have specific entry requirements.

Exceptional students, who wish to study four A Levels, must have achieved grades 9-8 in a minimum of four GCSE subjects, including the subject they wish to study, where relevant.

Attlee A Level Academy

Subject	Study Units
Biology	<ul style="list-style-type: none"> • Practical skills in biology • Exchange and transport • Biodiversity, evolution and disease • Communication, homeostasis and energy • Genetics, evolution and ecosystems
Business	<ul style="list-style-type: none"> • Leadership and decision making • Marketing performance • Operational and human resource performance • Analysing strategic position • Choosing strategic direction • How to pursue strategies • Managing strategic change
Chemistry	<ul style="list-style-type: none"> • Development of practical skills • Foundations in chemistry • Periodic table and energy • Core organic chemistry • Physical chemistry and transition elements • Organic chemistry and analysis
Classical Civilisation	<ul style="list-style-type: none"> • Ancient Greek and Roman literature • Society and life in the ancient world • Roman Britain • (Trips to Italy and Greece)
Computer Science	<ul style="list-style-type: none"> • Programming • Data structures • Computation • Data representation • Computer systems • Computer organisation and architecture • Consequences of uses of computing • Communication and networking • Systematic approach to problem solving • Databases • Big data • Functional programming • Non-exam assessment - the computing practical project

Subject	Study Units
Economics	<ul style="list-style-type: none"> • Microeconomics • Macroeconomics • Themes in economics
English Literature	<ul style="list-style-type: none"> • Plays, prose and poetry • Literary terminology • How to argue using evidence and analysis • How to organise and write essays
History	<ul style="list-style-type: none"> • Anglo-Saxon England • Norman England • Crusades • Mass media and social change 1882-2004
Italian	<ul style="list-style-type: none"> • Vocabulary and grammar • Daily life and society
Law	<ul style="list-style-type: none"> • Parliament and the courts • Criminal law • Machinery of law
Maths	<ul style="list-style-type: none"> • Pure mathematics • Statistics • Mechanics of mathematics
Further Maths (by invitation only)	<ul style="list-style-type: none"> • Core Pure Mathematics 1 – Proof, Complex numbers, Matrices, Further algebra and functions, Further calculus, Further vectors, Polar coordinates, Hyperbolic functions, Differential equations • Option 1 – Further Pure Mathematics 1, Further Statistics 1, Further Mechanics 1 and Decision Mathematics 1 • Option 2 – Further Pure Mathematics 2, Further Statistics 1, Further Mechanics 1, Decision Mathematics 1, Further Statistics 2, Further Mechanics 2 and Decision Mathematics 2
Media Studies	<ul style="list-style-type: none"> • Media concepts • Media platforms • Media debates • Media theories
Physics	<ul style="list-style-type: none"> • Development of practical skills • Foundations of physics • Forces and motion • Electrons, waves, and photons • Newtonian world and astrophysics • Particles and medical physics

Attlee A Level Academy

Subject	Study Units
Politics	<ul style="list-style-type: none"> • UK politics and core political ideas • UK Government and non-core political ideas • Global political issues
Psychology	<ul style="list-style-type: none"> • Human mind and behaviour • Biological, computer and forensic science • Biological and social influences on behaviour • Scientific experiments • Theory, empirical evidence and statistics
Religious Studies	<ul style="list-style-type: none"> • Philosophy of religion and ethics • Study of religion and dialogues
Sociology	<ul style="list-style-type: none"> • Families and households • Education • Crime and deviance • Beliefs in society • Sociological methods
Extended Project Qualification	<ul style="list-style-type: none"> • A qualification taken in addition to 3 A Levels which is designed to extend and develop study skills and learning • It is highly valued by universities as it demonstrates dedication to independent study • Students complete an in-depth project on a topic of their choice • Tutor acts as supervisor • EPQ carries UCAS points and is equivalent to half an A Level
Applied Science Level 3 OCR Technicals	<ul style="list-style-type: none"> • Science fundamentals • Laboratory techniques • Scientific analysis and reporting <p>You will need to study one A Level from the list above alongside this course.</p>
GCSE Science Programme	<p>Opportunity to re-sit GCSEs, study:</p> <ul style="list-style-type: none"> • Biology, Chemistry, Physics • Computer Science or Sociology • English Language and maths



Having Sixth Form

- Students will normally study three A Level subjects or two A Level subjects and one BTEC certificate
- We offer an Aiming High programme to equip high-achieving students with the skills necessary to thrive at the top universities
- Our Medics programme supports those students aspiring to Medicine degrees and ensures they are fully prepared for the rigorous university entrance process
- We offer a full Enrichment programme including Duke of Edinburgh's Award, the EPQ, Debate Society and a wide range of other clubs and activities

Subject	Study Units
Accounting	<ul style="list-style-type: none"> • Financial Accounting: Book-keeping to the trial balance and verifying the accuracy of the ledgers • Financial Accounting: Preparation of the Income Statement and Balance Sheet for sole traders, partnerships and Limited Companies • Financial Accounting: Ratio analysis and interpretation of the accounts • Management Accounting: Budgeting and variance analysis • Management Accounting: Costing techniques • Management Accounting: Social and ethical considerations
Art & Design (Fine Art)	<ul style="list-style-type: none"> • Build an individualised portfolio of wide-ranging practical work • Explore a variety of media and develop an ability to express observations and ideas in visual form • Participate in trips to galleries and work with professional artists • Develop analytical skills and knowledge of critical and contemporary issues in Art and Design
Art & Design (Digital Graphics)	<ul style="list-style-type: none"> • Build an individualised portfolio exploring digital and practical design • Follow a choice of design briefs from conception to realisation • Research and explore the work of contemporary artists and designers • Complete projects exploring Branding, Advertising, Editorials, Photo manipulation, Typography, and other processes • Explore Adobe software such as Photoshop, Illustrator, InDesign and After Effects
Art & Design (Interior & Architectural Design)	<ul style="list-style-type: none"> • Research and explore the work of contemporary designers • Make models using resistant materials and develop 3D representational skills • Visit contemporary buildings and spaces • Design an interior space using a selection of furniture • Create accurate CAD plans

Subject	Study Units
Art & Design (Photography)	<ul style="list-style-type: none"> • Learn how to use a DSLR camera • Develop digital editing skills using Photoshop and Nik Collection • Research and analyse the work of contemporary photographers • Create an individualised digital portfolio of work • Organise photoshoots in your independent time • Visit galleries and exhibitions
Art & Design (Product Design)	<ul style="list-style-type: none"> • Create and make prototype ideas that solve functional problems in a workshop environment • Research and explore the work of contemporary product, furniture and lighting designers • Visit design galleries and museum spaces • Create accurate CAD plans and 3D rendered models
Biology	<ul style="list-style-type: none"> • Development of practical skills in biology • Foundations in biology • Exchange and transport • Biodiversity, evolution and disease • Communication, homeostasis and energy • Genetics, evolution and ecosystems
Business	<ul style="list-style-type: none"> • Investigate real business situations; examine the problems they face • Understand that business behaviour can be studied from a range of perspectives; small scale to global • Generate enterprising and creative approaches to business opportunities, problems and issues • Acquire a range of relevant skills, including decision-making, problem solving and critical analysis • Apply numerical skills in a range of business contexts • Unit themes are: Marketing and People; Managing Business Activities; Business Decisions and Strategy; Global Business
Chemistry	<ul style="list-style-type: none"> • Development of practical skills • Foundations in chemistry • Periodic table & energy • Core organic chemistry • Physical chemistry and transition elements • Organic chemistry and analysis
Computer Science	<ul style="list-style-type: none"> • Develop and understand computing terms and concepts • Develop the expertise to analyse, design, program, test and document computer programs using Python • Carry out the development of a computer application for a real client • Study the organisation, structure of data and its transmission • Learn about data security and the social and legal implications of computing systems • Develop the capacity to think creatively, innovatively, analytically, logically and critically

Having Sixth Form

Subject	Study Units
Dance	<ul style="list-style-type: none"> • Complete a written exam that consists of both structured and essay style questions based on the set works that you study throughout the course • Perform a solo in the style of a chosen practitioner • Perform in a quartet in any chosen dance style • Choreograph a group dance based on a question set by the exam board • Develop your ability to work with others • Stretch your physical and creative abilities in new and exciting directions
Drama & Theatre	<ul style="list-style-type: none"> • Devise a performance using a written play stimuli and practitioner followed by an extended essay or presentation evaluating the process • Create a group performance based on a written play • Perform a range of monologues or duologues • Visit the theatre and write production reviews • Explore and write about a play script • Explore and write about a further play using a specific theatre practitioner
Economics	<ul style="list-style-type: none"> • Understand key aspects of economic theories and policies • Compare the likely effectiveness of economic policies • Engage in debate and discussion with fellow students • Explore Microeconomics • Explore Macroeconomics • Study themes in economics
English Language and Literature	<ul style="list-style-type: none"> • Study methods of linguistic and literary analysis • Become an independent reader and a skilled writer • Analyse, evaluate and interpret a range of texts • Remembered Places (an AQA-produced non-fiction anthology) • Imagined Worlds (The Handmaid's Tale, by Margaret Atwood) • Poetic Voices (Carol Ann Duffy poetry anthology) • Writing About Society (The Great Gatsby, by F. Scott Fitzgerald) • Dramatic Encounters (A Streetcar Named Desire, by Tennessee Williams)

Subject	Study Units
English Literature	<ul style="list-style-type: none"> • Improve your vocabulary • Present rational and well-structured arguments • Closely examine language and its effects • Develop your research and referencing skills • Improve your verbal and written communication skills • Strengthen your knowledge of literature and culture • Develop critical thinking
Film Studies	<ul style="list-style-type: none"> • Give your opinion on a wide range of films • Work with others to create a film sequence or a short film • Analyse performance, cinematography, editing and sound of individual films • Examine current successful films and explain the reasons for their success • Study the process of film-making, from finance to production and marketing • Look at how audiences appreciate films and stars in case studies of movie internet sites, forums and fan behaviour
French	<ul style="list-style-type: none"> • Read and understand texts • Write extended essays • Listen to and comprehend the spoken language • Understand the key social and cultural aspects of France • Express ideas and opinions about key modern issues in written form • Talk about important issues in French • Study a film in the first year and a novel in the second
Geography	<ul style="list-style-type: none"> • Study the water and carbon cycle • Global climate change and life on Earth • Case studies of local and distant environments and landscapes • Changing places – the nature and importance of place, including relationships, connections, meaning and representation • Landscape systems: Coastal systems and landscapes • Global systems and global governance • Population and the Environment • Fieldtrips: A 4-day residential trip to complete compulsory fieldwork unit

Having Sixth Form

Subject	Study Units
Geology	<ul style="list-style-type: none"> • Develop and understand geological terms and concepts • Study and handle a wide range of geological specimens • Have the opportunity to attend field trips both within Britain (Arran and Herne Bay) and elsewhere (Iceland) • Develop the observational and recording skills required by geologists
History	<ul style="list-style-type: none"> • Develop independent thought, analysis and evaluation • Understand historical terms and concepts • Study topics including Britain 1625-1701 - conflict, revolution and settlement; France in Revolution, 1774-99; Germany 1871-1990, united, divided, reunited • Explore the significance of events, individuals, issues and societies in History • Understand the nature of historical evidence and the methods used by historians in analysis and evaluation • Carry out an in-depth research-based investigation
Law	<ul style="list-style-type: none"> • Develop competence in using legal skills • Demonstrate ability to analyse a scenario by identifying the key facts from which legal issues arise • Analyse legislation by applying the rules and principles of statutory interpretation • Develop a basic understanding of the differences between criminal and civil law and between different sources of law including custom, statute law and common law • Construct clear, concise and logical legal arguments using appropriate terminology
Mathematics	<ul style="list-style-type: none"> • Widen and deepen your understanding of mathematical concepts • Learn and apply a wide range of mathematical techniques • Analyse and solve mathematical problems • Study concepts such as quantity, structure, space and change • Pure Mathematics - algebra, geometry, trigonometry, graphs, sequences and calculus • Mechanics – the study of motion and forces (links well with Physics) • Statistics - includes analysis of data and probability

Subject	Study Units
Further Mathematics	<ul style="list-style-type: none"> • Widen and deepen your understanding of mathematical concepts • Learn and apply a wide range of mathematical techniques • Study concepts such as quantity, structure, space and change • Use and interpret mathematics in modelling situations based on the real world • Pure Mathematics - algebra, geometry, trigonometry, graphs, sequences and calculus • Mechanics – the study of motion and forces (links well with Physics) • Statistics - includes analysis of data and probability • Discrete Maths - study of networks and optimisation
Mathematics – Core (AS equivalent, not a full A Level)	<ul style="list-style-type: none"> • Strengthen mathematical knowledge and skills gained at GCSE • Tackle problems in realistic contexts, relevant to other subjects • Cover a wide range of topics • Develop wider life skills by studying personal finance • Topics may include modelling, statistics, finance, working with exponentials, working and gradients, geometry and measures, risk, statistical problem-solving, use of technology • Core Maths is studied with three other A Levels
Media Studies	<ul style="list-style-type: none"> • Media Forms and Products - advertising and marketing, film), magazines, music videos, newspapers, online media, radio, television and video games • Theoretical Framework – consisting of Media Language; Representation; Media industries; Audiences • Develop knowledge and understanding of media products in relation to key social, cultural, economic, political and historical contexts • Media Concepts - forms, representations, institutions and audiences • Media Platforms - broadcasting; digital/web-based media (e-media) and print • Media Debates - reality TV, news values and moral panics • Media Theories - gender and ethnicity, consumption and genre theories

Having Sixth Form

Subject	Study Units
Music	<ul style="list-style-type: none"> • Study music scores in detail to learn how the structure of music works • Improve your performing ability (voice or instrument) • Compose music using the recording studio and Mac suite • Learn how to write about music in a structured way • Study music from The Western Classical Tradition, Modern Classical music (20th/21st Century), plus one of these three areas: Rock and Pop (1960-2000), Musical Theatre or Jazz (1920-1960)
Music Technology	<ul style="list-style-type: none"> • Create multi-track recordings in the music studio to make high quality productions • Learn MIDI sequencing and music composition techniques • Study commercial recordings and music technology production techniques and how they have changed over the years • Learn practical music technology skills - how to use editing, mixing and production techniques in real world scenarios
Philosophy	<ul style="list-style-type: none"> • Develop higher order critical thinking skills and evaluative arguments • Rigorously criticise existing philosophical arguments in a search for truth, understanding and clarification • Construct your own arguments, leading to balanced and informed judgements • First year units - Epistemology and Moral Philosophy • Second year units - Metaphysics of God and Metaphysics of Mind • Explore questions such as: Is the mind a separate substance from the body? What is knowledge? Can religious and ethical language be meaningful?
Physics	<ul style="list-style-type: none"> • Study topics such as light, energy, electricity and forces and motion in greater depth than at GCSE • Investigate quantum physics • Develop your practical skills by carrying out experiments • Medical physics - the use of x-rays and ultrasound in medicine, as well as diagnostic methods used in hospitals • Astrophysics – covering astronomy and the cosmos, force fields, energy and the evolution of the universe • Discover the latest research in physics

Subject	Study Units
Politics	<ul style="list-style-type: none"> • UK Politics and core political ideas – Democracy and Participation; Political Parties; Electoral Systems; Voting Behaviour and the Media; Conservatism; Liberalism; Socialism • UK Government and non-core political ideas - The Constitution; Parliament; The Prime Minister and the Executive; Sovereignty; Nationalism • Global political issues - The State and Globalization; Global Governance (political/economic/human rights/environmental); Power and Developments; Regionalism and the EU; Comparative Theories
Psychology	<ul style="list-style-type: none"> • Introduction to Psychology – Social Influence, Memory, Attachment, Psychopathology • Psychology in Context – Approaches in Psychology, Biopsychology and Research Methods • Issues and Options in Psychology – Schizophrenia, Gender, Forensic Psychology, Issues and Debates
Religious Studies	<ul style="list-style-type: none"> • Philosophy of religion and ethics • Arguments for the existence of God, Evil and Suffering • Miracles, Self and Life after Death • Ethical Theories - Introduction to Meta-Ethics, Free Will and Moral Responsibility • Study of religion and dialogues – Islam • Sources of Wisdom and Authority, Expression of Religious Identity, Religion and Science
Sociology	<ul style="list-style-type: none"> • Families and households – why family structure is changing • Education – why is it compulsory to attend school • Crime and deviance • Beliefs in society, the functions of religion • Methods of social research and theories

Ready to apply?

Go to our website www.ncclondon.ac.uk

Got a question?

Email info@ncclondon.ac.uk or call 0330 135 8000

Having Sixth Form

Subject	Study Units
Spanish	<ul style="list-style-type: none"> • Achieve effective communication in conversations • Read and understand texts • Write extended essays in Spanish • Listen to and comprehend spoken language • Study the key social and cultural aspects of Spain and South America • Express ideas and opinions about key modern issues • Study a film in the first year and a play in the second year
Extended Project Qualification	<ul style="list-style-type: none"> • A qualification taken in addition to 3 A Levels which is designed to extend and develop study skills and learning • It is highly valued by universities as it demonstrates dedication to independent study • Students complete an in-depth project on a topic of their choice • Tutor acts as supervisor • EPQ carries UCAS points and is equivalent to half an A Level

Single BTECs (equivalent to one A Level)

One BTEC can be chosen alongside two A Levels.
For full-time BTEC courses please see the relevant sections throughout this guide.

Subject	Study Units
Business	<ul style="list-style-type: none"> • Business Environments • Finance • Marketing • Personal and business finance • Practical work-related skills and work experience • The importance of being an effective manager • Develop skills in communication and IT
Digital Games Production	<ul style="list-style-type: none"> • Produce different games with comprehensive planning documents • Produce reports related to the gaming and entertainment industry • Participate in group and independent work • Develop analytical skills and transferrable skills such as creative thinking, literacy and numeracy • Critically engage with a rapidly changing and vibrant industry

Subject	Study Units
Health & Social Care	<ul style="list-style-type: none"> • Develop an understanding of how to meet individual care and support needs • Be motivated to work consistently and independently to achieve each unit • Understand the importance of deadlines and manage your time to meet them • Take part in discussions, debates, role plays and give presentations • Develop independent research skills • Develop communication skills and apply them to a range of health and social care settings
Information Technology	<ul style="list-style-type: none"> • Gain fundamental knowledge and skills in computing • Information Technology Systems • Creating Systems to Manage Information • Using Social Media in Business • Website Development
Law	<ul style="list-style-type: none"> • The law of negligence and the way claims, such as damage or losses from a car crash are dealt with in English law • How statutory rules are made and interpreted • How legislation is made outside of Parliament • Exploration of the various legal personnel involved in a criminal trial
Music Performance	<ul style="list-style-type: none"> • Plan, prepare and deliver a musical performance from start to finish • Explore music theory and its application through composition • Organise internal and external gigs, with marketing, front of house, backstage and technical elements • Preparation and performance of music as a soloist in front of an audience • Work as part of a musical ensemble
Performing Arts (Musical Theatre)	<ul style="list-style-type: none"> • Develop performance skills in all disciplines as an individual and as part of an ensemble • Gain experience of and perform in a wide range of theatrical productions • Devise and recreate work using a range of published scripts • Study the history of theatre from Shakespeare to Musical Theatre and its place within today's society • Develop an understanding of the role of a performer as well as director/choreographer
Sport	<ul style="list-style-type: none"> • Anatomy and Physiology • Fitness Training and Programming for health, sport and well-being • Professional Development in the sports industry • Practical sports performance

BTEC & Vocational

Business & Enterprise	52
Computing & Digital Industries	58
Construction & Building Services	62
Creative Arts, Design & Media	70
Early Years	78
Engineering	82
English for Speakers of Other Languages (ESOL)	86
Foundation Learning SEND	88
Hairdressing & Beauty Therapy	96
Health Sciences & Social Care	102
Hospitality & Culinary Arts	106
Motor Vehicle Technologies	110
Performing Arts	114
Science	118
Sport & Fitness	122
Tourism & Aviation	130
Uniformed Public Services	134

How to use this guide

Each one of our BTEC and vocational course pages has a QR code which you can scan on your smart phone. This will take you directly to the area you are interested in on our website, which has more detail.

Business & Enterprise

Our campuses are located near to London's main financial and business districts and you will benefit from having exposure to business mentors, work placements and visits to international businesses to expand your knowledge.

T-LEVELS **New for 2022-23**
T-Level in Business Management & Administration, see page 55.

98%
pass rate
for our BTEC
Business students
2020-21



Scan me
for more
information

Careers

- Accountant • Business Owner • HR Officer
- Investor • Marketing Manager • Product Buyer

Business Introductory Diploma BTEC

L1

Ardleigh Green Hackney Redbridge Tower Hamlets

Course outline

Build your awareness of the business sector and develop your skills required to work in it.

Progression

Level 2 certificate or diploma in business

Business Extended Certificate BTEC

L2

Ardleigh Green Epping Forest

Course outline

Develop your essential knowledge and skills for the modern day work place including team working, working to deadlines, presenting information and working to live briefs/projects.

Progression

Level 3 certificate or diploma in business

Business First Certificate BTEC

L2

Havering Sixth Form

Course outline

Develop knowledge and skills in the business sector that are essential for the modern day work place including team working, working to deadlines, presenting information and working to live briefs/projects.

Progression

Level 3 certificate or diploma in business

Business & Enterprise (cont.)

Business & Enterprise Technical Diploma

OCR

L2

Hackney Redbridge Tower Hamlets

Course outline

Develop your applied knowledge and practical skills in business administration, retail and customer service sectors.

Progression

Level 3 certificate or diploma in business

Business Extended Certificate

BTEC

L3

Ardleigh Gr. Epping F. Hackney Hav. Sixth Form Redbridge Tower H.

Course outline

Gain an understanding of the business environment, how to develop a marketing campaign and personal and business finance, whilst developing your practical work-related skills.

Progression

Apprenticeship, employment or university

Ready to apply?

Go to our website www.ncclondon.ac.uk

Got a question?

Email info@ncclondon.ac.uk or call 0330 135 8000

Business Extended Diploma

BTEC

L3

Havering Sixth Form

Course outline

Learn about business start-ups, financial decision-making, marketing techniques and the importance of being an effective manager.

Progression

Apprenticeship, employment or university

Business Foundation Diploma

BTEC

L3

Ardleigh Green Epping Forest Hackney Redbridge Tower Hamlets

Course outline

Develop knowledge and skills including marketing campaigns, digital marketing, customer service, event management, personal and business finance and recruitment and selection.

Progression

Apprenticeship, employment or university

Business Management & Administration

T-Level • New for 2022-23

L3

Ardleigh Green Redbridge Tower Hamlets

Course outline

You will learn about business operation and strategic leadership. You will apply your learning through a compulsory work placement in a business related area. You can follow a specific pathway, for example our Finance Pathway at our Tower Hamlets campus.

Progression

Higher apprenticeship, employment or university

Business Administration & Accounting

Administration & Office Skills Diploma

BTEC

L2

Ardleigh Green

Course outline

Develop your administrative, secretarial and personal assistant (PA) skills to get you started in your business administration career.

Progression

Level 3 diploma, employment

Administration & Office Skills Diploma

BTEC

L3

Ardleigh Green

Course outline

Gain advanced administration skills to develop your career as a personal assistant (PA) or office manager.

Progression

Apprenticeship, employment or university

Accounting Foundation Certificate

AAT

L2

Ardleigh Green

Redbridge

Course outline

Gain the practical skills, knowledge and understanding required to obtain employment as an accounts junior.

Progression

Level 3 diploma, employment

Accounting Advanced Diploma

AAT

L3

Ardleigh Green

Course outline

Develop the skills, knowledge and understanding required to obtain employment to work in accounts and finance.

Progression

Apprenticeship, employment or university

Legal Secretaries

CILEx

L2

Ardleigh Green

Epping Forest

Course outline

Learn skills such as touch typing and proof reading and gain knowledge around the main areas of law (criminal, civil, probate, corporate, family and conveyancing).

Progression

Level 3 course, employment

Legal Secretaries

CILEx

L3

Ardleigh Green

Epping Forest

Course outline

Gain advanced skills and knowledge required for working as a legal secretary.

Progression

Apprenticeship, employment or university

Computing & Digital Industries

Even if you are not sure what exactly you want to do with your life, a course in digital, ICT or computing can position you to transition into many other fields. This could include traditional IT firms, or entertainment, finance, engineering or law firms, all of which have a high demand for people with technical skills.

T-LEVELS **New for 2022-23**
T-Level in Digital Production, Design & Development, see page 61.

90%

of jobs will require
some digital element
within 20 years

www.gov.uk



Scan me
for more
information



Careers

- Cyber Security Analyst • IT Manager • IT Technician
- Programmer • Web Designer

Vocational Studies, ICT & Media Introductory Diploma

BTEC

L1

Ardleigh Green

Epping Forest

Hackney

Redbridge

Tower Hamlets

Course outline

Gain practical skills in a range of areas including: product branding, digital communication, using spreadsheets to solve problems and creating a website.

Progression

Level 2 certificate or diploma

IT Diploma

OCR

L2

Ardleigh Green

Course outline

Develop your practical skills through a range of assignments including: website and games development, spreadsheet modelling, customising software and animation.

Progression

Level 3 certificate or diploma

IT Users Diploma

NVQ

L2

Tower Hamlets

Course outline

Develop your knowledge and understanding of improving productivity using IT and optimising IT system performance. Gain software skills in: using databases, imaging, desktop publishing, spreadsheets, website and word processing.

Progression

Level 3 certificate or diploma

Computing & Digital Industries (cont.)

IT Extended Certificate

OCR

L2

Redbridge

Course outline

Develop your skills to work and communicate in the IT industry and gain knowledge of business IT skills, computer graphics and computer and database systems.

Progression

Level 3 certificate or diploma

IT Extended Certificate

BTEC

L2

Epping Forest Hackney Tower Hamlets

Course outline

Gain knowledge and understanding of the online world, technology systems, creating digital animations and graphics and grow your spreadsheet, database, software and website development skills.

Progression

Level 3 certificate or diploma

Computing National Foundation/ Extended Diploma

BTEC

L3

Tower Hamlets

Course outline

Gain computational thinking skills and mathematical concepts. Grasp the fundamental concepts of computer science, create websites, digital graphics, animation and mobile apps. There is also a focus on IT security systems and how businesses use social media.

Progression

Employment or university

IT National Foundation/ Extended Certificate

BTEC

L3

Epping Forest Hackney Redbridge Tower Hamlets

Course outline

Gain an insight into creating IT systems to manage and share information, alongside developing knowledge and skills in software development, web/content development, mobile apps and games design, programming and IT/business analysis support.

Progression

Apprenticeship, employment or university

IT National Foundation/ Extended Diploma

BTEC

L3

Ardleigh Green Epping Forest Hackney Redbridge Tower Hamlets

Course outline

You will study cyber-security and programming and grasp the main concepts of how to keep systems secure as well as learning C# and Python programming languages. You will have the opportunity to develop a mobile app as well as acquiring advanced web development skills.

Progression

Apprenticeship, employment or university

Digital Production, Design & Development

T-Level • New for 2022-23

L3

Ardleigh Green Redbridge Tower Hamlets

Course outline

You will study core theory, concepts and skills for industry along with specialist skills and knowledge for a career in the digital sector.

Progression

Apprenticeship, employment or university

Construction & Building Services

Gain the skills you need to work as a plumber, electrician, bricklayer, painter & decorator or carpenter. Or utilise your skills and learning to work in a managerial role such as a site supervisor.

3.1 million
people are employed
in the UK construction
industry. www.gov.uk

T-LEVELS

New for 2022-23

See page 69
for T-Level
courses.



Scan me
for more
information



Careers

- Builder • Carpenter • Electrician • Heating Engineer
- Painter & Decorator • Site Manager • Surveyor

Bricklaying Diploma

City & Guilds

L1

Epping Forest Hackney Rainham

Course outline

Develop the basic employment and practical skills and knowledge required in order to become a competent and employable bricklayer.

Progression

Level 2 Diploma in Bricklaying

Construction Skills Diploma

City & Guilds

L1

Rainham

Course outline

Learn new skills within construction including three of the following subjects: Bricklaying, Carpentry and Joinery, Plastering, Painting and Decorating, Construction Operations, Wall and Floor Tiling, Electrical and Plumbing.

Progression

Level 2 course in a specific trade

Construction (Carpentry) Extended Certificate

City & Guilds

L1

Epping Forest Tower Hamlets

Course outline

Learn how to produce basic woodworking joints and use hand and power tools safely.

Progression

Level 2 course



Construction & Building Services (cont.)

Construction (Painting & Decorating) Extended Certificate

City & Guilds

L1

Hackney Rainham

Course outline

Learn the art of preparing surfaces and creating decorative finishes.

Progression

Level 2 course

Electrical Installation Diploma

City & Guilds

L1

Epping Forest Hackney Rainham Tower Hamlets

Course outline

Gain basic electrical installation skills and knowledge that can be used in your future career.

Progression

Level 2 Diploma in Electrical Installations

Plumbing Studies Diploma

City & Guilds

L1

Epping Forest Hackney Rainham Tower Hamlets

Course outline

Gain basic plumbing installation skills and knowledge that can be used in your future career.

Progression

Level 2 Technical Certificate in Plumbing & Heating

Bricklaying Diploma

City & Guilds

L2

Rainham

Course outline

Develop and grow your practical skills and knowledge to become an employable bricklayer.

Progression

Level 3 course

Electrical Installations Diploma

City & Guilds

L2

Epping Forest Hackney Rainham Tower Hamlets

Course outline

Learn the theoretical aspects of the subject and apply them to practical tasks.

Progression

Level 3 Advanced Technical Diploma in Electrical Installation

Ready to apply?

Go to our website www.ncclondon.ac.uk

Got a question?

Email info@ncclondon.ac.uk or call 0330 135 8000

Construction & Building Services (cont.)

Painting & Decorating Diploma

City & Guilds

L2

Rainham

Course outline

Develop a range of skills including preparation of surfaces, painting, hanging wallpaper and decorative paint effects.

Progression

Apprenticeship, employment

Plumbing Studies Technical Certificate

City & Guilds

L2

Epping Forest

Hackney

Rainham

Tower Hamlets

Course outline

Gain an understanding of the skills required within the plumbing sector.

Progression

Level 3 Technical Diploma in Plumbing Studies

Site Carpentry Diploma

City & Guilds

L2

Rainham

Tower Hamlets

Course outline

Develop and widen your practical skills and knowledge to become an employable carpenter.

Progression

Level 3 carpentry course, apprenticeship or employment

Bricklaying Diploma

City & Guilds

L3

Rainham

Course outline

Learn, develop and practise the skills required for employment and/or career progression. This includes: repairing and maintaining structures; principles of organising, planning and pricing; constructing radial, battered, decorative and reinforced brickwork; constructing fireplaces and chimneys.

Progression

Level 3 HNC/ HND Construction & the Built Environment, employment or further study

Construction Foundation/Extended Diploma

(for site managers, architects and quantity surveyors)

BTEC

L3

Rainham

Course outline

Gain the skills and knowledge to build your career as a site manager, building surveyor, quantity surveyor, project manager, building engineer or facilities manager.

Progression

Level 4 HNC, university or employment

The Foundation Diploma is a one year course, however the majority of students stay on to year 2 to complete the Extended Diploma in Construction.

Construction & Building Services (cont.)

Electrical Installations Technical Diploma

City & Guilds

L3

Epping Forest Hackney Rainham Tower Hamlets

Course outline

Enhance your skills in theoretical aspects and testing of electrical installations.

Progression

Apprenticeship, employment

Plumbing Studies Technical Diploma

City & Guilds

L3

Epping Forest Rainham

Course outline

Enhance your skills in theoretical aspects and installing heating/hot water systems.

Progression

Apprenticeship, employment

Site Carpentry Diploma

City & Guilds

L3

Rainham

Course outline

Learn, develop and practise the skills required for employment and/or career progression. This includes: first fix flooring and roofing; second fixing operations; first fix roofing and stairs; second fixing double doors and mouldings.

Progression

Level 3 HNC/ HND Construction & the Built Environment, employment or further study

Construction T-Levels New for 2022-23

- Building Services Engineering
- Design, Surveying & Planning
- Onsite Construction

L3

Rainham

Course outline

You will learn the core knowledge and skills for entry to a range of construction occupations.

Progression

Apprenticeship, or employment

Ready to apply?

Go to our website www.ncclondon.ac.uk

Got a question?

Email info@ncclondon.ac.uk or call 0330 135 8000



Scan me
for more
information

Creative Arts, Design & Media

We provide courses that offer you academic theories aligned with the practical professional knowledge that will ensure you leave college with the right skills and competencies to compete successfully for jobs, or undertake further study at university.

T-LEVELS

New for 2022-23

T-Level in Digital Production, Design & Development, see page 77.

2.2 million

UK jobs in creative industries between Oct 2019 and Sept 2020

www.gov.uk



Careers

- Fashion Designer • Games Designer
- Graphic Designer • Photographer • Sound Engineer



Our learning company, Blue Orange, gives you the opportunity to work on real client briefs.

One example being the design and creation of the original New City College logo.

Art, Design & Media Introduction BTEC

L1

Epping Forest Hackney Redbridge Tower Hamlets

Course outline

Develop key transferrable and progression skills in relation to both Art & Design and Creative Media.

Progression

Level 2 Diploma in Art & Design or Creative Media

Art, Media & IT Vocational Studies BTEC

L1

Ardleigh Green

Course outline

Gain an introduction to the creative sector through developing ideas to create images, using cameras to explore imagery, creating 2D and 3D outcomes, developing problem solving skills, and planning an exhibition.

Progression

Level 2 Diploma in Art & Design or Creative Media or IT courses

Art & Design

Art & Design Diploma

BTEC

L2

Ardleigh Green Epping Forest Hackney Redbridge Tower Hamlets

Course outline

Explore a wide variety of materials, techniques and processes used in art and design. You will explore 3D design, ceramics, fine art, photography and graphics.

Progression

Apprenticeship, employment or university

Applied Art & Design National Diploma

BTEC

L3

Hackney

Course outline

Explore a range of creative techniques in textile design, ceramics, illustration, interior design and product design, whilst developing your creative skills.

Progression

Apprenticeship, employment or university

Art & Design National Extended Diploma

BTEC

L3

Epping Forest Tower Hamlets

Course outline

Explore a wide variety of materials, techniques and processes used in art and design. You will work in both traditionally and using digital media developing techniques in 3D design, ceramics, fine art, photography and graphics.

Progression

Apprenticeship, employment or university

Art & Design - Graphics & Illustration National Extended Diploma

BTEC

L3

Redbridge

Course outline

Explore 3D design, ceramics, fine art, photography and graphics using a wide variety of materials, techniques and processes to develop your skills to work as a traditional artist or designer.

Progression

Apprenticeship, employment or university

Art & Design - Graphic Design & Photography National Extended Diploma

BTEC

L3

Ardleigh Green

Course outline

Develop your graphics and photography skills through this exciting project-based course whilst creating your portfolio of work.

Progression

Apprenticeship, employment or university

Art & Design - Motion Graphics & VFX National Extended Diploma

BTEC

L3

Hackney

Course outline

Learn the ultimate skills you need to succeed when producing graphics for TV commercials, working on UX and UI design, or creating pitches for advertising agencies.

Progression

Apprenticeship, employment or university

Media

Creative Media Skills Diploma

BTEC

L2

Ardleigh Green Epping Forest Hackney Redbridge Tower Hamlets

Course outline

Explore film making, editing, lighting, studio work, location work, multimedia, photography, graphics and idents.

Progression

Level 3 course

Creative Media Production National Extended Diploma

BTEC

L3

Ardleigh Green

Course outline

Gain knowledge, skills and understanding of film and TV production, editing techniques, radio production, journalism, photography, animation and VFX, digital design and page layout and media theory.

Progression

Apprenticeship, employment or university

Creative Media Production - Digital Media National Extended Diploma

BTEC

L3

Epping Forest Redbridge Tower Hamlets

Course outline

Learn a variety of materials, techniques and processes used in creative media production. You will explore film making, editing, lighting, studio work, location work, multimedia, photography, graphics and idents.

Progression

Apprenticeship, employment or university

Creative Media Production - Digital Publishing National Extended Diploma

BTEC

L3

Havering Sixth Form

Course outline

Learn the technical skills and knowledge related to fields such as web design, journalism, digital graphic design, page layout (of text and images), photo editing, magazines and advertising.

Progression

Apprenticeship, employment or university

Creative Media Production - Games Animation & VFX National Extended Diploma

BTEC

L3

Ardleigh Green

Course outline

Gain knowledge, skills and understanding of the industry through design and development, developing story and concept art, game engines, and object-orientated design.

Progression

Apprenticeship, employment or university



Scan me for more information

Media (cont.)

Creative Media Production - Games Design National Extended Diploma BTEC

L3

Hackney Havering Sixth Form

Course outline

Gain the ultimate breadth of experience in designing assets, developing game dynamics and programming level complexities and uncover the games industry role that awaits you.

Progression

Apprenticeship, employment or university

Creative Media Production - TV & Film National Extended Diploma BTEC

L3

Havering Sixth Form

Course outline

Learn to use a wide range of digital media and software editing packages and create a digital portfolio showing evidence of practical assignments, written work and group projects.

Progression

Apprenticeship, employment or university

Digital Games Design National Extended Certificate BTEC

L3

Havering Sixth Form

Course outline

Develop your skills in game concept design, developing coding knowledge and construction of interactive games. You will also develop critical thinking skills and knowledge of the gaming industry.

Progression

Apprenticeship, employment or university

Digital Production, Design & Development T-Level • New for 2022-23

L3

Ardleigh Green Epping Forest Hackney Redbridge Tower Hamlets

Course outline

You will study core theory, concepts and skills for industry along with specialist skills and knowledge for a career in the digital sector.

Progression

Apprenticeship, employment or university

Ready to apply?

Go to our website www.ncclondon.ac.uk

Got a question?

Email info@ncclondon.ac.uk or call 0330 135 8000



Scan me
for more
information

Early Years

Our courses start at Level 1 and you can study up to Level 3, including T-Levels, which gives you 'license to practice in the sector' and then up to Levels 4 and 5 if you really want to advance your career into management, administration, teaching or owning your own nursery business.

92%
of students
achieved their
qualification
in 2020-21



Scan me
for more
information



Careers

- Childminder • Nursery Assistant • Nursery Nurse
- Primary School Teacher • SEND Officer

Caring for Children CACHE Diploma NCFE

L1

Ardleigh Green Epping Forest Hackney Redbridge Tower Hamlets

Course outline

Gain skills and knowledge needed to care for young children.

Progression

Level 2 NCFE
CACHE Diploma
for Early Years
Practitioner or
apprenticeship

Early Years Practitioner CACHE Diploma NCFE

L2

Ardleigh Green Epping Forest Hackney Redbridge Tower Hamlets

Course outline

Develop your skills to work with children aged from birth to five years, and gain knowledge of working with children aged five to seven.

Progression

Level 3 NCFE CACHE
Technical Diploma
in Childcare &
Education, T Level in
Education & Care or
apprenticeship

Childcare & Education CACHE Technical Certificate/Diploma NCFE

L3

Ardleigh Green Epping Forest Hackney Redbridge Tower Hamlets

Course outline

Gain valuable experience as a trainee childcare worker, building up practical skills and gaining confidence when working with children.

Progression

Employment or
university

T-LEVELS / Early Years (cont.)

T-Levels offer an exciting opportunity for learners to combine theory and practical, ensuring employer engagement throughout the study programme. This will include a minimum of 350 placement hours.

Entry requirements

- Five or more GCSEs at grades 9-4 including English Language & maths
- Level 2 Diploma for the Early Years Practitioner
- Where there are specific subjects required at GCSE we can discuss your grades with you when you come to enrol



Education & Childcare

T-Level

L3

Epping Forest

Hackney

Redbridge

Course outline

Combine classroom theory, practical learning and industry placement to learn practical skills and demonstrate competencies needed to work with children.

Whilst on campus you will study in our specialist training facility, which includes a practical nursery room where you will gain real-life experience.

Progression

Employment, higher/degree level apprenticeship or university



Scan me for more information

Ready to apply?

Go to our website www.ncclondon.ac.uk

Got a question?

Email info@ncclondon.ac.uk or call 0330 135 8000

Engineering

Our engineering courses are taught at our state-of-the-art training facility in Rainham. We have long-standing partnerships with employers who offer job placements and apprenticeships.

Engineers are innovative and inventive, so if you are interested in how things work and enjoy finding solutions to technical problems, these courses will suit you.

T-LEVELS

New for 2022-23

See page 85 for T-Level courses.

An experienced Engineer earns around

£48,000

which is 62% higher than the UK's national average salary.

www.prospects.ac.uk



Scan me for more information

Careers

- Design Engineer • Electrical Engineer
- Mechanical Engineer • Plant Technician • Welder

Engineering Performing Operations Certificate

BTEC

L1

Rainham

Course outline

Gain a broad-based understanding and knowledge of the practical sides of engineering.

Progression

Level 2 Diploma or Certificate in Engineering

Engineering First Extended Certificate

BTEC

L2

Rainham

Course outline

You will cover topics including, investigating an engineering product, machining techniques, using and interpreting engineering information, maths for engineering, mechanical engineering and electronic circuit design.

Progression

Level 3 Diploma in Engineering

Fabrication & Welding Practice Certificate

ABC

L2

Rainham

Course outline

Learn the latest fabrication and welding techniques, materials, processes and practices.

Progression

Level 3 Fabrication & Welding Practice Certificate/Diploma



Engineering (cont.)

Performing Engineering Operations (Mechanical & Electronic Pathways) Diploma ABC

L2

Rainham

Course outline

Acquire appropriate practical engineering skills and knowledge through three mandatory units and a further three optional units.

Progression

Level 3 Diploma in Engineering

Fabrication & Welding Practice Certificate/Diploma

ABC

L3

Rainham

Course outline

Progress your knowledge from basic welding and fabrication skills to a more highly developed understanding of equipment functions and how materials behave when subjected to the welding process.

Progression

Apprenticeship, employment, or higher education

Engineering Diploma

BTEC

L3

Rainham

Course outline

Learn a broad range of engineering areas and develop your understanding of how scientific principles and practical knowledge can create products and systems that work safely and effectively.

Progression

Apprenticeship, employment, or higher education

Engineering Technologies Subsidiary Diploma

BTEC

L3

Rainham

Course outline

Develop extensive underpinning knowledge and related practical skills in a range of engineering subjects including: engineering and environmental health and safety, mechanical engineering principles, engineering organisational efficiency and improvement, further engineering mathematics, further electrical and electronic principles, further engineering science, electrical and electronic principles, advanced turning and milling.

Progression

Apprenticeship, employment, or higher education

Engineering T-Levels New for 2022-23

- Design & Development
- Engineering, Manufacturing, Processing & Control
- Maintenance, Installation & Repair

L3

Rainham

Course outline

You will develop the core knowledge and skills that are needed for entry to a range of:

- design and development occupations
- engineering, manufacturing, process and control occupations
- maintenance, installation and repair occupations

Progression

Apprenticeship, or employment

English for Speakers of Other Languages (ESOL)

We offer a range of courses which will help you improve your English language skills in speaking, listening, reading and writing.

If English is not your main language, our English for Speakers of Other Languages (ESOL) courses are designed for you. You will develop English Language skills for life and work in the UK and make rapid progress towards the GCSE, vocational and A Level courses we also offer.

Highest achievement rates

for Entry and Level 1 students in London and Essex.



Scan me for more information



English

English for Speakers of Other Languages (ESOL)



Ardleigh Green

Epping Forest

Hackney

Redbridge

Tower Hamlets

Our ESOL courses enable you to:

- Achieve an English qualification recognised by employers and academic institutions nationally
- Progress quickly onto GCSE, A Level, vocational courses or Higher Education
- Manage everyday situations and develop knowledge of life in the United Kingdom
- Learn other subjects including: business, cooking, creative media, maths, humanities, sport, IT, science, employability and GCSE maths and Italian
- Go on trips and visits to develop an understanding of British culture and sites of interest

Course outline

As well as improving your English, you will have the opportunity to gain nationally recognised qualifications in other subjects such as maths, IT and science.

You will also enjoy enrichment trips which will allow you to put your new skills into practice. Our experienced teachers will help you decide which course is best for you and work with you to gain a nationally recognised qualification.

Foundation Learning SEND

With superb facilities our SEND provision provides an inclusive and safe learning environment.

We are passionate about students achieving their full potential through holistic, innovative and experiential learning opportunities. We offer a comprehensive range of training and support to learners with special needs and disabilities to help them achieve their aspirations.

Our students have access to the following types of support:

- Smaller class sizes
- In-class learning mentor support
- Lunch and break time supervision
- Support with transport
- Personal care
- One-to-one support
- Learning Zones (drop-in areas for additional help with studies)
- Specialist software
- Exam access arrangements
- Counselling
- Mental Health adviser
- Communicator
- Small group support



Scan me for more information

Discovery

E

Hackney

Course outline

This pathway is designed for students with complex needs. The course will prepare students for adulthood by building skills in developing routines, improving communication and making choices/decisions that will support them to gain the maximum possible control over their daily lives.

Progression

Towards Independence course

Bungalow Pre-Entry/Entry 1

E

Havering Sixth Form

Course outline

Specifically designed to meet students' individual needs as identified in their EHCP which covers community participation, healthy living, nature and environment, home management, ICT and creativity, cooking, gym/yoga, Makaton, English Language and maths.

Progression

Towards Independence course

Explorer

E

Epping Forest Redbridge Tower Hamlets

Course outline

This course is designed for students with complex needs. The core aim is to develop independence through communication development.

Progression

Move On course

Foundation Learning SEND (cont.)

Encounter

E

Tower Hamlets

Course outline

The course will prepare students with complex needs for adulthood by enabling them to reach their full potential to develop routines, improve communication and make choices and decisions which enable them to gain the maximum possible degree of control over their daily lives.

Progression

Move On
or Towards
Independence
courses

Enterprise Catering & Hospitality

E

Hackney

Course outline

This course uses our Independent and Lemon Tree cafes to develop learning opportunities and confidence. Students will work in a team to deliver basic catering and hospitality services in the college.

Progression

Catering course
or Supported
Internship
Programme (SIP)



Scan me
for more
information

Vocational Explorer

E

Hackney

Course outline

Students will explore the world of work and develop work-readiness skills, attend vocational tasters, participate in work experience in college and/or in the wider community, access to the community and travel training, develop personal safety awareness and how to lead a healthy lifestyle, and develop social skills and skills to build relationships.

Progression

Enterprise course
or Supported
Internship
Programme (SIP)

Skills for Work

E

Epping Forest Redbridge Tower Hamlets

Course outline

This course uses small enterprise opportunities across college to develop learning opportunities and confidence. Students will work in a team to deliver horticultural, retail and other business services in the college. This model provides experience of working in a team, customer service, useful vocational skills and lots of personal development.

Progression

Supported
Internship
Programme (SIP),
entry level jobs

Foundation Learning SEND (cont.)

Towards Independence

E

Hackney Havering Sixth Form Redbridge Tower Hamlets

Course outline

Develop independence skills, communication, social skills and work skills through Enterprise projects including out in the community, communication, ICT, cookery, self-advocacy/personal development, English Language and maths, and creative enterprise (running a business).

Progression

Skills for Work course

Move On

E

Epping Forest Redbridge Havering Sixth Form Tower Hamlets

Course outline

Develop personal and social skills and confidence to enable students to progress into further learning, supported internship or work.

Progression

Life Skills, Skills for Work courses or Supported Internship Programme (SIP)

Cafe Project

E

Tower Hamlets

Course outline

This course uses our Canary View restaurant to develop learning opportunities and confidence. Students will work in a team to deliver basic catering and hospitality services in the college.

Progression

Skills for Work course or Supported Internship Programme (SIP)

Life Skills

E

Hackney Havering Sixth Form

Course outline

The course will prepare students for adulthood by enabling them to gain the maximum possible degree of independence in their daily lives. Students will build the confidence that they need to develop skills for work, in the community, independent living and self-care.

Progression

Vocational Explorer, Foundation Pathway or Enterprise courses

Enterprise Business

E

Hackney

Course outline

This course uses small enterprise opportunities across college to develop learning opportunities and confidence. Learners will work in a team to deliver horticultural, retail and other business services in the college.

Progression

Vocational, Explorer or Supported Internship Programme (SIP)



Scan me for more information

Foundation Learning SEND (cont.)

Foundation Pathway

E

Epping Forest Havering Sixth Form Redbridge Tower Hamlets

Course outline

This flexible course is designed for SEND students who are undecided on where to progress to, unsure of what course they want to do, need additional support and time to progress.

Progression

Mainstream college courses

Preparing for Supported Internship Programme (SIP)

E

Redbridge

Course outline

This course is for students who want to explore the world of work, develop work-readiness skills and progress to the SIP courses to gain paid employment.

Progression

Supported Internship Programme (SIP)

Aspirations Programme

E

Epping Forest Havering Sixth Form Tower Hamlets

Course outline

Develop confidence, independence and work-skills through cooking, sports, digital skills and horticulture; and pathways including exploring communication through creative arts, community integration, independent living skills and healthy living.

Progression

Other SEND courses or work placement

Supported Internship Programme (SIP)

E

Epping Forest Redbridge Havering Sixth Form Tower Hamlets

Course outline

The programme supports students with an EHCP to gain paid work through work placements.

Progression

External progression into work

Skills for Employment, Training & Personal Development Certificate Pathway

L1

Havering Sixth Form

Course outline

This flexible course is designed for students who are undecided on where to progress to, unsure of what course they want to do, need additional support and time to progress.

Progression

Mainstream college courses

Schools Links

E

Hackney Redbridge Tower Hamlets

Course outline

This course is for students at school and interested in coming to college the year after, the course aims, to prepare students for further study and progression.

Progression

Other SEND courses

Hairdressing & Beauty Therapy

We offer a choice of hairdressing and beauty courses which are recognised by the industry as the qualifications needed to begin your career. You will mix both classroom theory with practical training and be supported at every stage by our expert staff. You will develop your skills in our professional-standard salons.

Work and train
in our salons
and studios with
real paying
clients.



Scan me
for more
information

Careers

- Beauty Technician • Junior Stylist
- Make-up Consultant • Salon Manager

Hair & Beauty Sector Introduction Diploma

City & Guilds

L1

Epping Forest

Course outline

You will study basic beauty, hair and media make-up techniques enabling you to gain experience in face painting, manicures, hairstyling and shampooing.

Progression

Level 2 Diploma in Beauty Therapy or Hair & Media Make-up or apprenticeship

Hair & Media Make-up Diploma

City & Guilds

L2

Epping Forest

Course outline

Develop the knowledge and skills required for a career in this exciting and rewarding industry. Subjects include applying make-up, eyelash and brow treatments, photographic make-up, body art, tanning techniques, the art of colouring and dressing hair and making hair additions.

Progression

Level 2 Diploma in Beauty Therapy or Level 3 Diploma in Theatrical, Special Effects, Hair & Media Makeup



Hairdressing

Hairdressing Diploma

City & Guilds

L1

Ardleigh Green Epping Forest

Course outline

Develop hairdressing skills and knowledge to enable you to perform basic services and assist others in the salon.

Progression

Level 2 Diploma in Hairdressing

Hairdressing Diploma

City & Guilds

L2

Ardleigh Green Epping Forest

Course outline

Gain a good knowledge of hairdressing and develop a sound awareness of the industry. You will complete practical assessments on real clients.

Progression

Level 2 Diploma in Hairdressing

Hairdressing Diploma

City & Guilds

L3

Ardleigh Green Epping Forest

Course outline

Develop your practical skills to an advanced level through a variety of techniques and practical assessments on real clients in our state-of-the-art hair salons.

Progression

Apprenticeship, employment, Level 4 Salon Management



Beauty Therapy

Beauty Therapy Diploma

City & Guilds

L1

Ardleigh Green Redbridge

Course outline

Develop beauty therapy skills and knowledge to enable you to perform basic services and to assist others in the salon.

Progression

Level 2 Diploma in Beauty Therapy or Hair & Media Make-up

Beauty Therapy Diploma

City & Guilds

L2

Ardleigh Green Epping Forest Redbridge

Course outline

Develop the basic knowledge, skills and competencies to perform basic facials, eye care treatments, make-up, manicure and pedicure and waxing.

Progression

Level 3 Diploma in Beauty Therapy Techniques

Beauty Therapy Techniques

City & Guilds

L3

Ardleigh Green Epping Forest Redbridge

Course outline

Learn and practise all aspects of beauty therapy treatments on a wide range of customers as well as on each other. You will learn advanced techniques in both practical and theory for body and facial electrotherapy and body massage treatments.

Progression

Level 4 course or Employment

Theatrical, Special Effects, Hair & Media Makeup

City & Guilds

L3

Epping Forest

Course outline

Learn advanced make-up techniques for film, television and stage alongside other media purposes including basic hairdressing, media make-up, wigs and postiche, character make-up and special effects.

Progression

Employment or university

Ready to apply?

Go to our website www.ncclondon.ac.uk

Got a question?

Email info@ncclondon.ac.uk or call 0330 135 8000



Scan me for more information

Health Sciences & Social Care

With increasing and rewarding job opportunities in health and care this is a great area to learn, get qualified and progress into work. We prepare you for careers in nursing, midwifery, social work, counselling and psychology.

Work placements are mandatory to give students the insight and experience of working on the frontline.

T-LEVELS
New for 2022-23
T-Level in Health,
see page 105.

92%
qualification
pass rate in
2020-21



Scan me
for more
information

Careers

- Midwifery • Nursing • Physiotherapy • Psychology
- Social Work • Youth Work

Health & Social Care, Children & Young People's Settings Introduction CACHE

L1

Ardleigh Green Epping Forest Hackney Redbridge Tower Hamlets

Course outline

Gain an understanding of how health and social care and childcare services work. Units include: the importance of healthy eating and drinking, development through the lifespan, the range of service provision and roles within the sector, principles and values, equality and inclusion.

Progression

Level 2 CACHE
Extended Diploma in
Health & Social Care
or apprenticeship

Health & Social Care Extended Diploma CACHE

L2

Ardleigh Gr. Epping F. Hackney Hav. Sixth Form Redbridge Tower H.

Course outline

Develop skills, knowledge and understanding in a number of subjects, including duty of care, equality and inclusion, stroke awareness, working in health and social care, understanding sensory loss and protection and safeguarding.

Progression

Level 3 Foundation
Diploma in Health
and Social Care,
apprenticeship or
employment

Health Sciences & Social Care (cont.)

Health & Social Care National Diploma

BTEC

L3

Ardleigh Gr. Epping F. Hackney Hav. Sixth Form Redbridge Tower H.

Course outline

Develop advanced practical skills and knowledge in a range of subjects, including communication and rights, individual needs, health and social care services, diet, health and human lifespan development.

Progression

Employment or university

Health & Social Care National Foundation Diploma

BTEC

L3

Ardleigh Gr. Epping F. Hackney Hav. Sixth Form Redbridge Tower H.

Course outline

Develop advanced practical skills and knowledge in a range of subjects, including communication and rights, individual needs, health and social care services, diet, health and human lifespan development.

Progression

Employment or university

Health & Social Care (Health Studies) National Extended Diploma

BTEC

L3

Ardleigh Gr. Epping F. Hackney Hav. Sixth Form Redbridge Tower H.

Course outline

Develop advanced knowledge and skills in human lifespan development, working in the industry, anatomy and physiology, work experience and promoting public health.

Progression

Employment or university

Health

T-Level • New for 2022-23

L3

Epping Forest Redbridge

Course outline

You will study in our cutting-edge training facility which includes a replica hospital ward and a science laboratory. You will learn in our specialised environment and gain real-life experience.

Progression

Apprenticeship, employment or university

Ready to apply?

Go to our website www.ncclondon.ac.uk

Got a question?

Email info@ncclondon.ac.uk or call 0330 135 8000



Scan me
for more
information

Hospitality & Culinary Arts

The food and beverage sector is demanding skilled and talented staff. If you have ambition and drive the opportunities are there for you. Your training includes paid work in one of our two commercial restaurants – Rouge (Redbridge) and OKN1 (Hackney). Here you will work under professional head chefs, prepare dishes for paying customers and learn how to run a profitable commercial restaurant.



Join our award winning student chefs

Champions of:

- Nestlé Professional Toque d'Or Culinary Competition
- Dingley Dell Dirty Dozen Competition



Scan me for more information

Careers

- Barista • Commis Chef • Event Management
- Hotel Manager • Maître D • Sommelier

Hospitality Industry Introduction Certificate

City & Guilds

L1

Hackney Redbridge

Course outline

Gain a working understanding of all aspects of basic food preparation, cooking and restaurant service.

Progression

Level 2 City & Guilds Diploma in Culinary Skills or Level 2 City & Guilds Diploma in Hospitality Services

Hospitality Services Diploma

City & Guilds

L2

Hackney Redbridge

Course outline

Gain a strong understanding of all aspects of professional food preparation, cooking and restaurant service, including maintenance of a safe, hygienic and secure working environment, working effectively as part of a hospitality team, maintenance of food safety when storing, preparing and cooking food, preparing and clearing areas for table service, serving food at the table, preparing and cooking meat, poultry, vegetable and pasta dishes.

Progression

Level 3 City & Guilds Diploma in Professional Cookery or Level 3 City & Guilds Diploma in Food & Beverage Service Supervision

OKN1



Hospitality & Culinary Arts (cont.)

Culinary Skills Diploma (Professional Chef)

City & Guilds

L2

Redbridge

Course outline

Develop your knowledge and learn the latest skills and approaches to hospitality industry practices and learn how to prepare, cook, and present a range of food items.

Progression

Level 3 Diploma in Professional Cookery or Food and Beverage Service Supervision, apprenticeship, employment

Professional Cookery Diploma

City & Guilds

L2

Hackney

Course outline

Develop your knowledge and learn the latest skills and approaches to hospitality industry practices and learn how to prepare, cook, and present a range of food items.

Progression

Level 3 Diploma in Professional Cookery or Food and Beverage Service Supervision, apprenticeship, employment



Scan me
for more
information

Food & Beverage Service Supervision Diploma

City & Guilds

L3

Hackney Redbridge

Course outline

Develop the skills and techniques required to deliver food and beverage service to customers, including bar service, silver service and table theatre.

Progression

Level 4 BTEC Higher National Diploma in Hospitality & Management, apprenticeship, employment or university

Professional Cookery Diploma

NVQ

L3

Redbridge

Course outline

Learn new skills and techniques in preparing and producing dishes of every kind. Gain an understanding of practical gastronomy, and the exciting area of food development as well as taking your culinary skills to the next level.

Progression

Apprenticeship, employment or university

Ready to apply?

Go to our website www.ncclondon.ac.uk

Got a question?

Email info@ncclondon.ac.uk or call 0330 135 8000

Motor Vehicle Technologies

Britain is home to major car and commercial car manufacturers, including specialist, premium and sports car producers. It is constantly evolving and at the forefront of advances in green technology. You will be trained in our car maintenance garages at our Ardleigh Green, Hackney and Tower Hamlets campuses.



Over
4 million
were employed
in the UK motor
industry in 2020



Scan me
for more
information

Careers

- Breakdown Mechanic • Car Engineer
- Formula 1 Engineer • Motor Vehicle Technician

Motor Vehicle Technology Introduction

IMI • City & Guilds

E3

Ardleigh Green

Hackney

Course outline

Learn through a combination of mandatory and optional units which provides you with the flexibility of achieving and progressing in small manageable steps.

Progression

Level 1 course

Motor Vehicle Maintenance & Repair

IMI

L1

Ardleigh Green

Course outline

Learn about the maintenance and repair of motor vehicles and the various jobs that are available within the motor vehicle industry.

Progression

Level 2 Motor Vehicle Maintenance & Repair Diploma

Vehicle Accident Repair Diploma

IMI

L1

Ardleigh Green

Course outline

Gain specialist skills required to work in motor vehicle maintenance and repair.

Progression

Level 2 course, apprenticeship, employment

Motor Vehicle Technologies (cont.)

Vehicle Maintenance Diploma

City & Guilds

L1

Hackney Tower Hamlets

Course outline

A basic introduction to repairing different types of vehicles.

Progression

Level 2 course

Light Vehicle Maintenance & Repair Principles Diploma

IMI • City & Guilds

L2

Ardleigh Green Hackney Tower Hamlets

Course outline

Develop your skills and knowledge of maintaining and repair different types of vehicles.

Progression

Level 3 course

Motor Vehicle Body Repair & Paint Diploma

IMI

L2

Ardleigh Green

Course outline

Develop specialist skills in a range of areas including: spray painting techniques, minor damage repair, M.E.T. stripping and refitting, panel preparation and welding and panel fabrication.

Progression

Level 3 course, apprenticeship or employment

Light Vehicle Maintenance & Repair Principles Diploma

IMI • City & Guilds

L3

Ardleigh Green Hackney

Course outline

Develop your skills for supervising others, running your own business or moving to a diagnostic technician level.

Progression

Apprenticeship, employability or university



Scan me for more information

Ready to apply?

Go to our website www.ncclondon.ac.uk

Got a question?

Email info@ncclondon.ac.uk or call 0330 135 8000

Performing Arts

If you love acting, singing, music, music technology or dance, a performing arts course is the starting point for a rewarding career. Our tutors have tremendous industry experience and can help you succeed.

Depending on your interests you will have the opportunity to perform shows in the college's theatres, or focus on more technical roles such as sound engineering.

363,700

jobs generated
by the arts & culture
sector, per year
in the UK

www.artscouncil.org.uk



Scan me
for more
information



Careers

- Actor • Dancer • Director • Musician • Singer
- Sound Engineer • Theatre Manager • Technical Roles

Music Industry Skills Extended Certificate

BTEC

L2

Ardleigh Green

Course outline

Develop your knowledge, skills and understanding of performance and production, music composition, music production and practice, instrument skills, and sound engineering.

Progression

Level 3 National Foundation Diploma in Music or Media Production, apprenticeship or employment

Music Performance & Production National Extended Diploma

BTEC

L3

Ardleigh Green

Course outline

Develop your knowledge skills and understanding on specialist pathways in performance and production. Both roles will include self-directed projects and planning for your next steps into the industry using our outstanding facilities.

Progression

Level 3 Extended or Subsidiary Diploma courses, apprenticeship or employment



**NEW
VISION
THEATRE**

Performing Arts (cont.)

Music Performance National Extended Certificate

BTEC

L3

Having Sixth Form

Course outline

Develop your all-round musicianship and gain a solid foundation in music ensemble and solo performance.

Progression

Apprenticeship, employment or university

Performing Arts - Industry Skills National Extended Certificate

BTEC

L2

Ardleigh Green Epping Forest Redbridge

Course outline

Introducing you to the traditional disciplines of acting, physical theatre and dance, and also elements of technical theatre and production allowing you to develop skills for traditional roles and recorded and digital work.

Progression

Level 3 course

Ready to apply?

Go to our website www.ncclondon.ac.uk

Got a question?

Email info@ncclondon.ac.uk or call 0330 135 8000

Performing Arts (Musical Theatre) National Extended Certificate

BTEC

L3

Having Sixth Form

Course outline

Develop a wide range of performance skills in music, drama and dance. This will cover a broad range of genres, increasing your understanding of how performers work and how performance has evolved over time. You will also learn about production techniques.

Progression

Apprenticeship, employment or university

Performing Arts Practice National Extended Diploma

BTEC

L3

Ardleigh Green Epping Forest Redbridge

Course outline

Develop and explore performance styles, create performance material, learn skills for performing for an audience and plan your career in the performing arts industry.

Progression

Apprenticeship, employment or university



Scan me
for more
information

Science

Students will be taught by subject specialists, and you will gain the theoretical knowledge and practical skills needed to succeed in higher-level study or to enter scientific careers.

Many of our students progress to university and enter careers as pharmacists, radiographers, microbiologists, nurses and teachers to name a few.

Our students
achieved a
99%
pass rate in
2020-21



Scan me
for more
information

Careers

- Anaesthetist • Biomedical Scientist • Doctor
- Forensic Scientist • Laboratory Technician
- Pharmacist • Radiographer • Researcher

Applied Science & Technology Diploma BTEC

L1

Ardleigh Green Redbridge Tower Hamlets

Course outline

Develop your knowledge and understanding in Physics, Biology and Chemistry whilst improving your vocational practical skills.

Progression

Level 2 Diploma in Applied Science

Applied Science & Technology Diploma BTEC

L2

Ardleigh Green Redbridge Tower Hamlets

Course outline

Gain knowledge, understanding and skills through units including principles of science, chemistry and our Earth, energy and our universe, biology and our environment, applications of chemical substances and physical science, health applications of life science and scientific skills.

Progression

Level 3 BTEC Foundation/Extended Diploma in Applied Science

Applied Science National Foundation/Extended Diploma BTEC

L3

Ardleigh Green Redbridge Tower Hamlets

Course outline

Gain fundamental knowledge, skills and understanding to consider a career in your chosen pathway - Biomedical Science, Analytical and Forensic Science or Physical Science.

Progression

Level 3 BTEC National Extended Diploma in Applied Science, apprenticeship, employment or university

Science (cont.)

Applied Science Pathways in Extended Diploma

BTEC

L3

Ardleigh Green Redbridge Tower Hamlets

Course outline

We offer specialist units which allow you to acquire the knowledge and skills to progress into your chosen pathway.

Pathways: Biomedical Science, Analytical and Forensic Science and Physical Science.

Progression

Apprenticeship, employment or university

Science National Extended Diploma

BTEC

L3

Havering Sixth Form

Course outline

Study a wide range of science subjects covering aspects of biology, chemistry, physics and maths, subjects include fundamentals of science, working in the science industry, physiology of human body systems, chemical laboratory techniques, medical physics techniques and using mathematical tools in science.

Progression

Apprenticeship, employment or university



Scan me for more information



Ready to apply?

Go to our website www.ncclondon.ac.uk

Got a question?

Email info@ncclondon.ac.uk or call 0330 135 8000

Sport & Fitness

Our courses are designed to prepare you for a wide choice of careers within the industry. Learn from professional coaches who will share their knowledge and skills with you. We have partnerships with Tottenham Hotspur Football Club and the London Lions Basketball Team.



97%

of sports & fitness students said they made the right choice by coming to New City College

Student Survey 2020



Scan me for more information

Careers

- Fitness Instructor • Nutritionist • Personal Trainer
- Physiotherapist • Sports Coach

Sports Academy & Development Centre Pathways

Add one of our exciting Sports Pathways to your course!

Students will have the opportunity to be part of one of our sector leading sports academy and development programmes. These combine elite level coaching, fixtures and competitions with students' studies.

Our pathways are open to all abilities and experience levels. They are designed to enrich students' knowledge and understanding of all aspects of sport and performance.

They are not solely about elite performance, although the high level partnerships provide strong talent identification and development pathways.

How to apply for a pathway online:

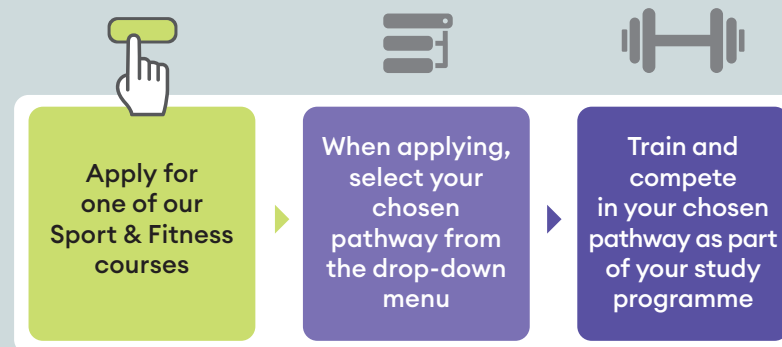

Pathway details on next page

Pathways in detail

Tottenham Hotspur Education & Football Development Centre

- World-class partnership programme
- Elite level coaching, from full-time Tottenham Hotspur academy coaches
- Work placements at Tottenham Hotspur Coaching Excellence Centre
- Direct employment with Tottenham Hotspur

It's not about becoming a football player, it's about having a career in sport.

Offered at:

Epping Forest | Hackney | Havering Sixth Form | Redbridge | Tower Hamlets



London Lions Basketball Academy

- Exposure to elite coaching and player development
- A perfect grounding and springboard into a career in sport
- There is a realistic elite player pathway
- The very best players could one day make the Lion's senior squad

Offered at these campuses:

Epping Forest | Hackney | Havering Sixth Form | Redbridge | Tower Hamlets



Legends Boxing Gym

- Open to both male & female students, train to become a professional boxer, or just for fitness!
- Learn to box and how to coach from professional boxing coaches
- Ideal for those interested in a career in the fitness industry or becoming a boxing coach

Offered at these campuses:

Epping Forest | Hackney | Redbridge | Tower Hamlets



110 Beyond Your Limits Athletics Academy

- Elite training facilities at Lee Valley Indoor Athletics Centre and the London Community Stadium
- Coached by English record holder, World and Olympic Medalist in the 110m hurdles, Tony Jarrett; and former GB international 110m hurdler, Gianni Frankis
- Elite level coaching, in excellent facilities, and take part in regional and national championships

Offered at these campuses:

Epping Forest | Hackney | Havering Sixth Form | Redbridge | Tower Hamlets



Coaching Academy

- Make your sports qualification come to life
- Students run PE sessions, after school sports clubs and competitions with local schools and sports clubs
- High quality work-related activities on a weekly basis throughout the year

Offered at these campuses:

Epping Forest | Hackney | Redbridge | Tower Hamlets

NEW
CITY
FITNESS



Sport & Fitness (cont.)

Sport & Active Leisure Award

BTEC

L1

Epping Forest Hackney Redbridge Tower Hamlets

Course outline

Gain the skills and knowledge for your future career in the sports industry. You will cover practical based units such as working in a team and taking part in sport and exercise, as well as theory-based units such as how the body works.

Progression

Level 2 Sport courses

Fitness Instructing Certificate

YMCA

L2

Epping Forest Hackney Redbridge

Course outline

Gain the skills and knowledge to pursue a career as a gym instructor. You will study the key theory behind gym-based exercise in units such as nutrition and physiology as well as developing your practical skills in units such as circuit training and supporting clients.

Progression

Level 3 Personal Training, other Level 3 course or employment

Sports Coaching Certificate

NVQ

L2

Redbridge

Course outline

Gain experience in PE and coaching through a range of topics including: planning, leading and reviewing activity sessions, health and safety, equality and diversity, supporting the work of a team, managing equipment.

Progression

Level 3 Certificate in PE & School Sport or Sport Extended Diploma

Sport Extended Certificate

BTEC

L2

Havering Sixth Form

Course outline

Gain the skills and knowledge to pursue your chosen career in the sports industry. You will develop practical abilities to lead and coach sport sessions, alongside developing your underpinning knowledge in nutrition, anatomy and physiology.

Progression

Level 3 courses

Sports Studies Diploma

VTCT

L2

Epping Forest Tower Hamlets Hackney

Course outline

Develop both your practical ability to lead and coach sports sessions as well as your underpinning knowledge in topics such as sport nutrition, anatomy and physiology.

Progression

Level 3 sport courses



Scan me for more information

Sport & Fitness (cont.)

PE & School Sport Certificate

NVQ

L3

Redbridge

Course outline

Build your knowledge and gain a greater understanding of programmes of study for PE, the national curriculum and the environment in which you will be operating.

Progression

Employment or university

Personal Training Diploma

YMCA

L3

Epping Forest

Hackney

Redbridge

Course outline

Develop the skills and knowledge to pursue a career as a personal trainer. You will study the key theoretical principals behind personal training in units such as anatomy and physiology and bespoke exercise design, as well as developing your practical skills in units such as sports conditioning and exercise programme instruction.

Progression

Employment or university

Ready to apply?

Go to our website www.ncclondon.ac.uk

Got a question?

Email info@ncclondon.ac.uk or call 0330 135 8000

Sport Foundation/Extended Diploma

BTEC

L3

Epping Forest

Hackney

Redbridge

Havering Sixth Form

Course outline

Develop your knowledge in the theory behind what makes a great coach/leader and also enhance your own practical skills. You will also study subjects such as psychology, anatomy and physiology.

The Foundation Diploma is a one year course, however the majority of students stay on to year 2 to complete the Extended Diploma in Sport.

Progression

Apprenticeship, internship, employment or university

Sport Science Foundation Diploma

BTEC

L3

Epping Forest

Hackney

Course outline

Enhance your underpinning knowledge of subjects such as sports nutrition, anatomy and physiology, biomechanics and research methods.

Progression

Apprenticeship, internship, employment or university



Scan me
for more
information

Tourism & Aviation

Whether you want to be a holiday rep, travel agent or air cabin crew, we make your learning fun and interactive. Gain a general understanding of the world of travel, aviation, tourism, hospitality, entertainment, airport and airline related industries. We have a model aircraft-based classroom and excellent industry links which set us apart in providing the best experience for our students.

By 2025, Britain is forecast to have a tourism industry worth over

£257 billion

www.visitbritain.org



Scan me for more information



Careers

- Airline Cabin Crew • Customer Service
- Logistics Manager • Tour Operator
- Travel Agent • Travel Resort Rep

Travel & Tourism First Certificate BTEC

L2

Havering Sixth Form

Course outline

Gain a broad knowledge and understanding of the sector. You will study units including: UK travel and tourism destinations, development of travel and tourism in the UK, international travel and tourism destinations, factors affecting worldwide travel and tourism, customer experience, business environments, promotion and sales, employment opportunities and organising a travel and tourism study visit.

Progression

Level 3 Extended Diploma

Air Cabin Crew Diploma City & Guilds

L2

Epping Forest

Course outline

Develop your skills, knowledge and understanding to progress into a career as air cabin crew.

Progression

Level 3 course, apprenticeship or employment

Tourism & Aviation (cont.)

Travel & Tourism Foundation/Extended Diploma

BTEC

L3

Epping Forest

Havering Sixth Form

Course outline

Learn about the many opportunities in travel and tourism and gain an understanding of the value of the industry locally, nationally and internationally. Develop research skills in order to find out about specific tourist destinations and gain an understanding of the attractions on offer.

The Foundation Diploma is a one year course, however the majority of students stay on to year 2 to complete the Extended Diploma in Travel & Tourism.

Progression

Apprenticeship, employment or university



Scan me
for more
information

Ready to apply?

Go to our website www.ncclondon.ac.uk

Got a question?

Email info@ncclondon.ac.uk or call 0330 135 8000



Uniformed Public Services

Our courses will prepare you for working in many different careers in the uniformed public services. This includes preparing you to work in the fire and police services, armed forces, immigration or paramedic services.

Our partnership with the University of Cumbria's London campus in Limehouse means that our students can progress to the first year of the BSc in Policing degree.

94%
qualification
success rate
2020-21



Scan me
for more
information

Careers

- Army • Firefighter • HM Revenue & Customs • Navy
- Paramedic • Police Officer • Security

Public Services First Extended Certificate BTEC

L2

Epping Forest Havering Sixth Form

Course outline

Form the fundamental knowledge and understanding of public service principles.

Units include: The role and work of the public services, working skills.

There are also optional specialist units providing an opportunity to develop a broader understanding of the sector.

Progression

Level 3 BTEC Extended Diploma in Public Services or employment

Public Services Extended Diploma BTEC

L3

Epping Forest Hackney Havering Sixth Form

Course outline

Develop your skills, knowledge, understanding and fitness required by our public services. You will cover subjects including: government, policies, leadership and teamwork, understanding discipline, physical preparation, health and lifestyle, outdoor and adventurous expeditions and responding to emergency service incidents.

Progression

Employment or university

In partnership with:

University of
Cumbria 

14-16 Key Stage 4

Our curriculum for 14-16 year old students offers a personalised education suited to individual levels of ability and need.

Classes take place at our Arbour Square campus in Tower Hamlets and our Ardleigh Green and Rainham campuses in Havering.

Students are able to study core subjects including English, Maths and Science as well as other GCSE subjects.

Our experienced teachers assess students when they first join us and plan the most appropriate level of education. Students can also study vocational qualifications at Level 1 and Level 2, such as Applied Science, Travel & Tourism, Performing Arts, Beauty & Hairdressing and Construction.

We also offer Prince's Trust qualifications in social and work-ready skills from Entry Level to L2. There is very good progression to A Levels and vocational subjects at Level 2 and 3 in and out of the college.

We have one of the largest and most successful English language departments in London. Our success rates in English language courses are high and our students gain confidence and make rapid progress in their English studies.

Courses for Adults

Look beyond today, retrain and upskill, with us.

With opportunities for everyone, we will help you realise your potential. We offer exciting and challenging courses - with all the support you'll need to succeed - from pre-entry to postgraduate level. We have the vitality to help you break boundaries and think big.

Most people pay no or low course fees. Free courses include English and maths up to GCSE level, Digital Skills for beginners, ESOL,

Level 3 courses through the new National Skills Fund and a whole host of distance learning options. Many people don't pay fees on other courses too (you will be required to provide evidence).

We look forward to helping you to achieve something great.



Campus locations

Ardleigh Green Campus

Ardleigh Green Road
Hornchurch
RM11 2LL

Attlee A Level Academy

Arbour Square
London
E1 0PT

Epping Forest Campus

Borders Lane
Loughton
IG10 3SA

Hackney Campus

Falkirk Street
Hackney
N1 6HQ

Havering Sixth Form Campus

Wingletye Lane
Hornchurch
RM11 3TB

Rainham Campus

New Road
Rainham
RM13 8GP

Redbridge Campus

Chadwell Heath Lane
Chadwell Heath
RM6 4XT

Tower Hamlets Campus

Poplar High Street
London
E14 0AF

 info@ncclondon.ac.uk

 0330 135 9000

 www.ncclondon.ac.uk

Follow us on:

